

Data Sheet

Customer: _____

Product: DIP Power Inductor – PC Series

Size : 0808/0908/1212

Issued Date: 20-Nov.-2015

Edition: Ver. 1

Record of change

Date	Ver.	Description	Page
20-Nov.-2015	1		

HITANO ENTERPRISE CORP.

7F-7, No. 3, Wu Chuan 1st Road, New Taipei Industrial Park,
New Taipei City, TAIWAN, R.O.C.

Tel: +886 2 2299 1331 (Rep.)

Fax: +886 2 2298 2466, 2298 2969

Prepared by	Checked by	Approved by	Accepted by (customer)
25-Oct.-2023	25-Oct.-2023	25-Oct.-2023	
Hwa Wu	Andy Hsu	Arthur Su	

DIP POWER INDUCTOR

PC SERIES

■ Features

- Density design, small size, and low cost
- Comparatively range rated current and high inductance
- Low DCR and high dip stability

■ Applications

- Personal Computers
- Variety of Battery Power Equipment
- DC Power Supply Circuits



Shape & Dimensions

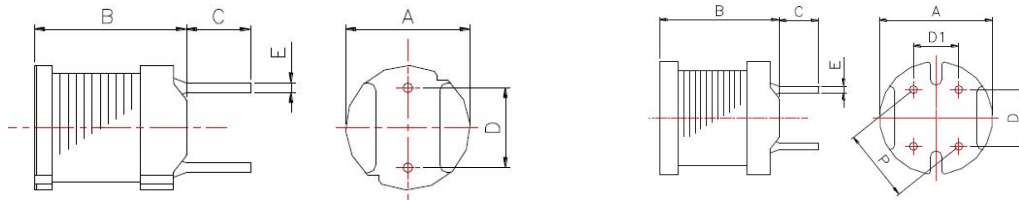

Type	A	B max.	C	D	D1	E	P
DRGH664	6.0±0.5	6.5	4.0±1.0	4.0±0.3	–	0.50±0.1	–
DRGH855	7.8±0.5	5.5	5.0±1.0	5.0±0.3	–	0.65±0.1	–
DRGH875	7.8±0.5	7.5	5.0±1.0	5.0±0.3	–	0.65±0.1	–
DRGH895	7.8±0.5	9.5	5.0±1.0	5.0±0.3	–	0.65±0.1	–
DRGH110	10.0±0.5	10.5	3.5±1.0	5.0±0.3	4.0±0.3	0.70±0.1	6.40±0.5

◆ Part Numbering

PC 0808 M 1R0 M □□
 (1) (2) (3) (4) (5) (6)

- (1) **Product name** : PC series
- (2) **Shapes and dimensions**: Refer to the following pages
- (3) **Type** : M type and I type (refer to Fig. 1)
- (4) **Inductance**: 3 digits, Example : 1R0 = 1.0uH, 100 = 10uH, 101 = 100uH, 102 = 1000uH
- (5) **Tolerance** : K: ±10%, M: ±20% (special tolerance available on request)
- (6) **Internal Code**

DIP POWER INDUCTOR

PC SERIES

■ Electrical Characteristics

DRGH664 Type(□:Tolerance):

Part No	L (μ H)	Tolerance	Test Condition	DCR (Ω) max.	IDC (A) max.
DRGH664□B220	22	M	1KHz, 0.1V	0.11	1.27
DRGH664□B270	27	M	1KHz, 0.1V	0.14	1.14
DRGH664□B330	33	M	1KHz, 0.1V	0.17	1.03
DRGH664□B390	39	M	1KHz, 0.1V	0.19	0.95
DRGH664□B470	47	M	1KHz, 0.1V	0.23	0.87
DRGH664□B560	56	M	1KHz, 0.1V	0.26	0.80
DRGH664□B680	68	M	1KHz, 0.1V	0.28	0.72
DRGH664□B820	82	M	1KHz, 0.1V	0.39	0.66
DRGH664□B101	100	K	1KHz, 0.1V	0.43	0.59
DRGH664□B121	120	K	1KHz, 0.1V	0.54	0.54
DRGH664□B151	150	K	1KHz, 0.1V	0.64	0.48
DRGH664□B181	180	K	1KHz, 0.1V	0.74	0.44
DRGH664□B221	220	K	1KHz, 0.1V	0.96	0.40
DRGH664□B271	270	K	1KHz, 0.1V	1.12	0.36
DRGH664□B331	330	K	1KHz, 0.1V	1.48	0.33
DRGH664□B391	390	K	1KHz, 0.1V	1.66	0.30
DRGH664□B471	470	K	1KHz, 0.1V	1.91	0.27
DRGH664□B561	560	K	1KHz, 0.1V	2.31	0.25
DRGH664□B681	680	K	1KHz, 0.1V	2.67	0.23
DRGH664□B821	820	K	1KHz, 0.1V	3.10	0.21
DRGH664□B102	1000	K	1KHz, 0.1V	4.45	0.19

DIP POWER INDUCTOR

PC SERIES

■ Electrical Characteristics

DRGH855 Type(□:Tolerance):

Part No	L (μ H)	Tolerance	Test Condition	DCR (Ω) max.	IDC (A) max.
DRGH855□B100	10	M	1KHz, 0.1V	0.07	2.50
DRGH855□B120	12	M	1KHz, 0.1V	0.08	2.40
DRGH855□B150	15	M	1KHz, 0.1V	0.09	2.10
DRGH855□B180	18	M	1KHz, 0.1V	0.10	2.00
DRGH855□B220	22	M	1KHz, 0.1V	0.12	1.70
DRGH855□B270	27	M	1KHz, 0.1V	0.14	1.60
DRGH855□B330	33	M	1KHz, 0.1V	0.17	1.40
DRGH855□B390	39	M	1KHz, 0.1V	0.21	1.30
DRGH855□B470	47	M	1KHz, 0.1V	0.24	1.20
DRGH855□B560	56	M	1KHz, 0.1V	0.31	1.10
DRGH855□B680	68	M	1KHz, 0.1V	0.34	1.00
DRGH855□B820	82	M	1KHz, 0.1V	0.40	0.93
DRGH855□B101	100	K	1KHz, 0.1V	0.52	0.81
DRGH855□B121	120	K	1KHz, 0.1V	0.59	0.76
DRGH855□B151	150	K	1KHz, 0.1V	0.71	0.67
DRGH855□B181	180	K	1KHz, 0.1V	0.89	0.62
DRGH855□B221	220	K	1KHz, 0.1V	1.04	0.54
DRGH855□B271	270	K	1KHz, 0.1V	1.28	0.49
DRGH855□B331	330	K	1KHz, 0.1V	1.47	0.44
DRGH855□B391	390	K	1KHz, 0.1V	1.67	0.41
DRGH855□B471	470	K	1KHz, 0.1V	1.95	0.38
DRGH855□B561	560	K	1KHz, 0.1V	2.83	0.35
DRGH855□B681	680	K	1KHz, 0.1V	3.25	0.32
DRGH855□B821	820	K	1KHz, 0.1V	3.82	0.31
DRGH855□B102	1000	K	1KHz, 0.1V	5.28	0.25
DRGH855□B122	1200	K	1KHz, 0.1V	6.03	0.23
DRGH855□B152	1500	K	1KHz, 0.1V	7.15	0.21
DRGH855□B182	1800	K	1KHz, 0.1V	8.26	0.20
DRGH855□B222	2200	K	1KHz, 0.1V	11.1	0.18
DRGH855□B272	2700	K	1KHz, 0.1V	13.1	0.16
DRGH855□B332	3300	K	1KHz, 0.1V	15.9	0.14
DRGH855□B392	3900	K	1KHz, 0.1V	18.0	0.13
DRGH855□B472	4700	K	1KHz, 0.1V	23.9	0.12
DRGH855□B562	5600	K	1KHz, 0.1V	26.8	0.11
DRGH855□B682	6800	K	1KHz, 0.1V	31.7	0.098
DRGH855□B822	8200	K	1KHz, 0.1V	46.5	0.088
DRGH855□B103	10000	K	1KHz, 0.1V	55.7	0.081

